

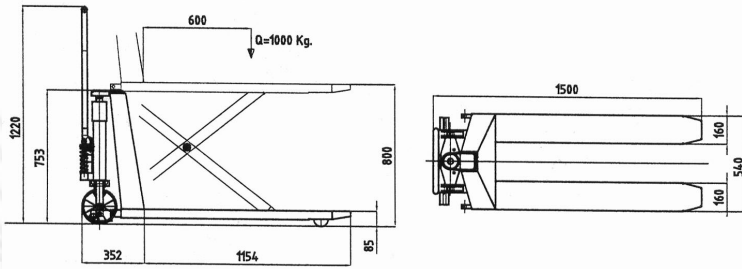

TP-X & TPE-X Manual & Electric Highlifters Manufactured In Stainless Steel.

The TP-X and TPE-X highlifters are designed to lift a pallet or stillage to a comfortable working height to reduce repetitive bending and stretching. Lifting is either manual hydraulic or by battery-electric pump.

- Capacity 1000 Kg
- Manufactured from 100% 304 grade stainless steel, ideal for use in food, chemical and pharmaceuticals industries.
- The electric version truck is protected to IP54 so can be hose washed, the manual machine can be power-washed.
- Suitable for working in areas down to -30°C.
- Trucks carry CE mark and comply with all current safety legislation.



The TP-X Hand Hydraulic High-Lifter

- Capacity 1000 Kg.
- Single ram pump design—stronger and more reliable than telescopic rams used on many other trucks.
- Robust pump unit can be power-washed.
- Lift height 800 mm.
- Also available in other fork width 685 mm and fork lengths of up to 2000 mm.
- Trucks carry CE mark and comply with all current safety legislation.



TP-X

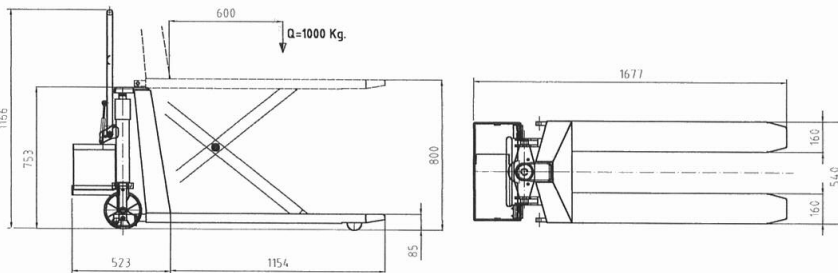

The TPE-X Hand Hydraulic High-Lifter

- Capacity 1000 Kg
- Robust pump unit can be power-washed.
- Supplied complete with heavy duty battery and external battery charger. Battery isolator switch is fitted for safety.
- Also available in other fork width 685 mm and fork lengths of up to 2000 mm.
- Trucks carry CE mark and comply with all current safety legislation.



TPE-X